

# Thank you for downloading The **PoliteType**

The Polite Type is a regular .ttf font that you can install on your computer, just as regular fonts are installed. The usual way to install a font is:

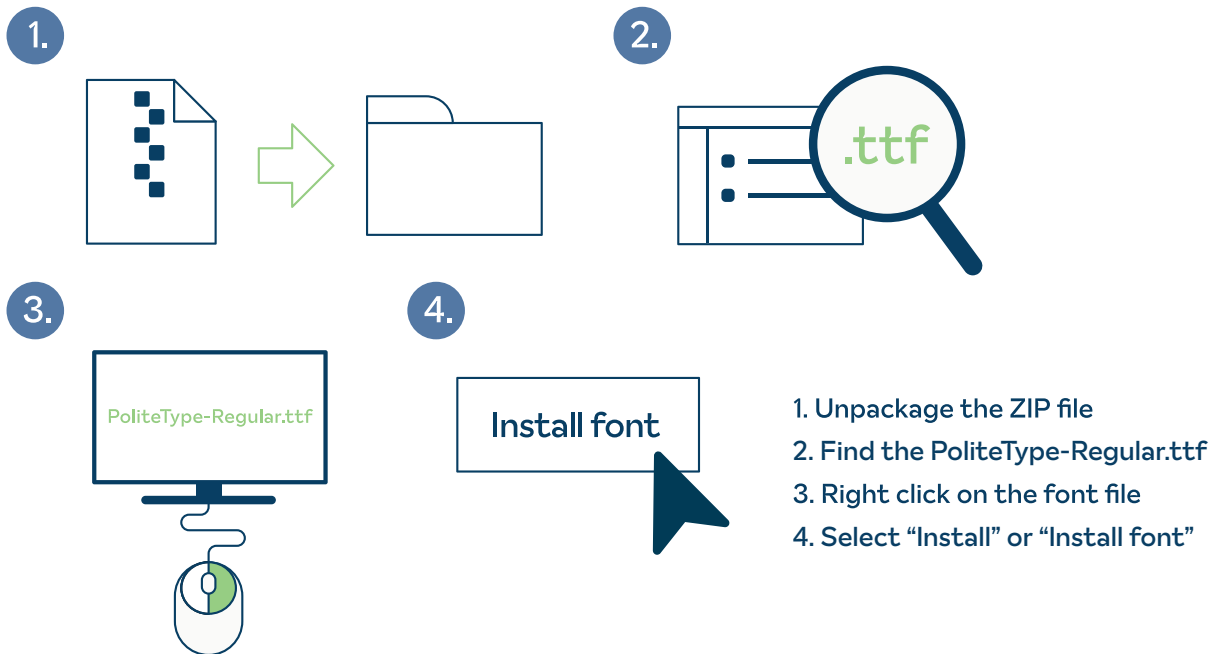

The font uses a ligature substitution feature to replace offensive language with more polite alternatives. This feature might not be active on some applications by default. To get the substitution feature to work on your software, please do the following:

1. Select the text where The PoliteType is used
2. Right click and select "Font"
3. Select "Advanced"
4. Check the option "Use contextual alternates"
5. Set Ligatures to "All"

